

# ZAZA2 SWITCH

By  
**KO  
NO  
FIT**

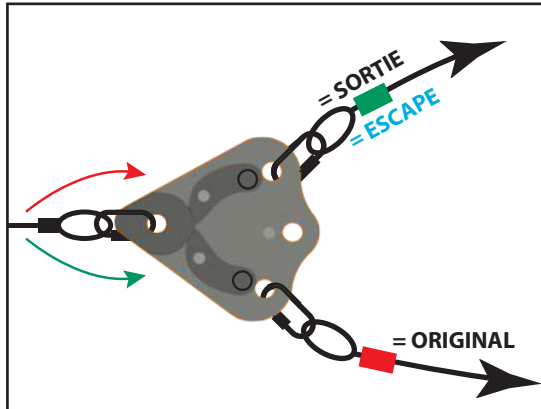

## AVANTAGES / ADVANTAGES

- Échappatoire / Escape
- Bifurcation / Diversion
- Dépassement / Overtaking

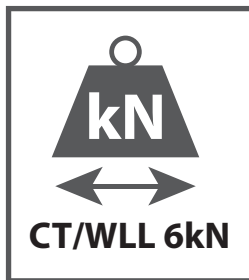

**Safety Line / Ligne de vie :**  
ø 12 mm or 1/2 "

Galvanized steel wire rope with metal core /  
Câble acier galvanisé avec âme métallique :

-7x19 / 1x19  
-Non rotating wire rope / Anti-giratoire  
-6x26 Swaged/ Compacté

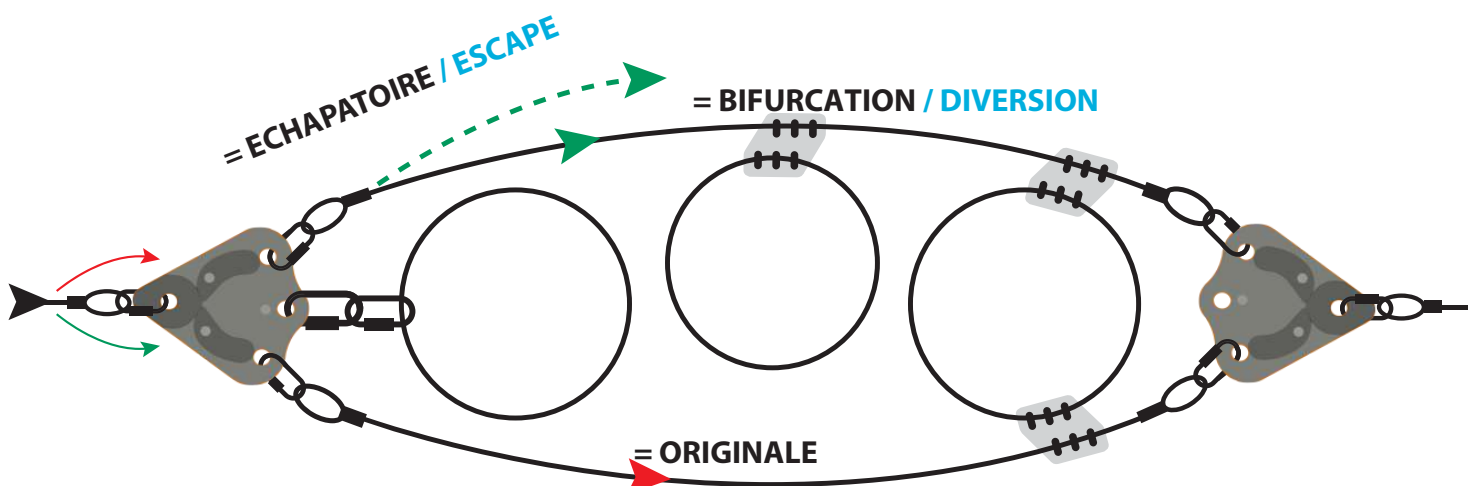
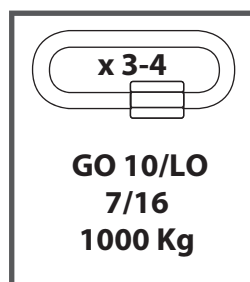
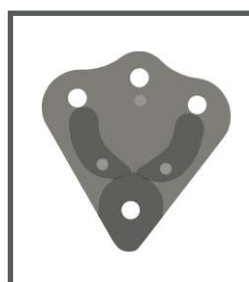
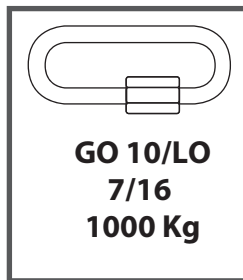

EXEMPLE de MONTAGE NON CONTRACTUEL  
EXAMPLE of NOT CONTRACTUAL ASSEMBLY

# Opération 1

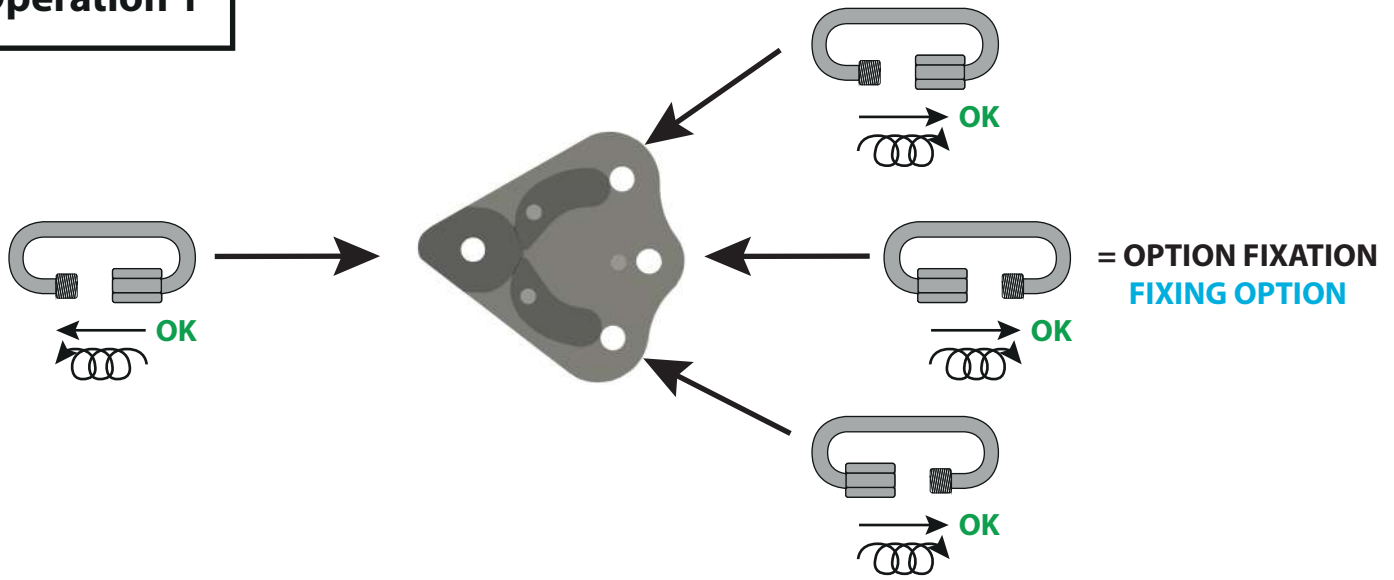

# Opération 2

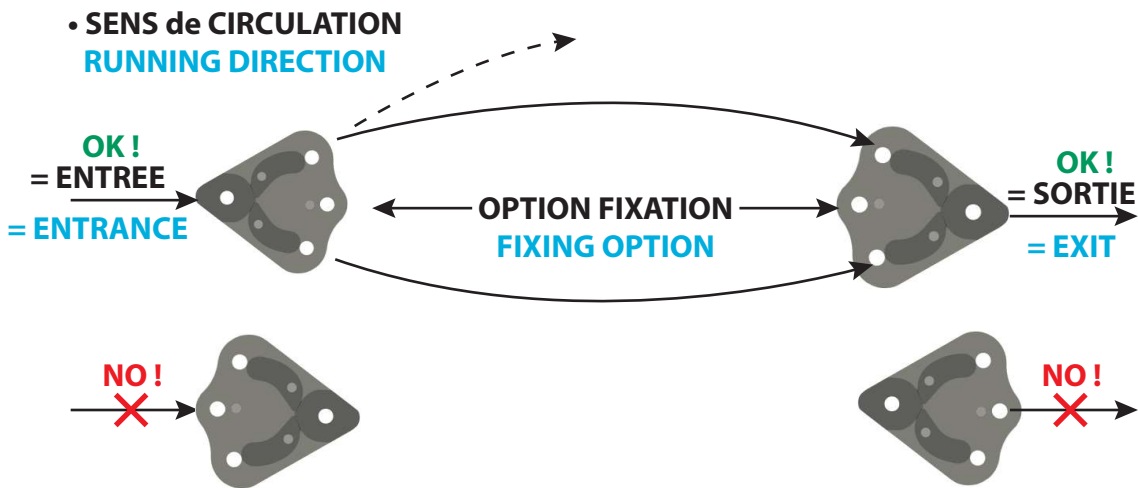

# Opération 3

• RECOMMANDATION MONTAGE  
RECOMMENDATION OF ASSEMBLY

MONTAGE SOUPLE  
CABLE D'ENTREE  
= FACILITE de MANOEUVRE  
FLEXIBLE ASSEMBLY  
ENTRANCE CABLE  
= EASY TO USE

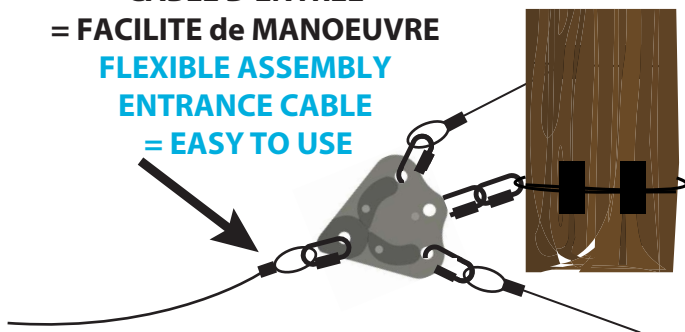

## NORMES DE MONTAGE STANDARDS OF ASSEMBLY



EN 15567-1  
EN 13411-1/7  
STANDARDS - ACCT

MONTAGE SOUPLE DU CABLE  
D'ENTREE = ROTATION CROCHET 180°  
FLEXIBLE ASSEMBLY ENTRANCE  
CABLE = 180° ROTATION for the HOOK



< 60°

Angle mini entre les câbles  
Minimum angle between cables

